

配置図

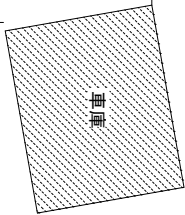

前面通路 (県道79号・芸北大朝線)

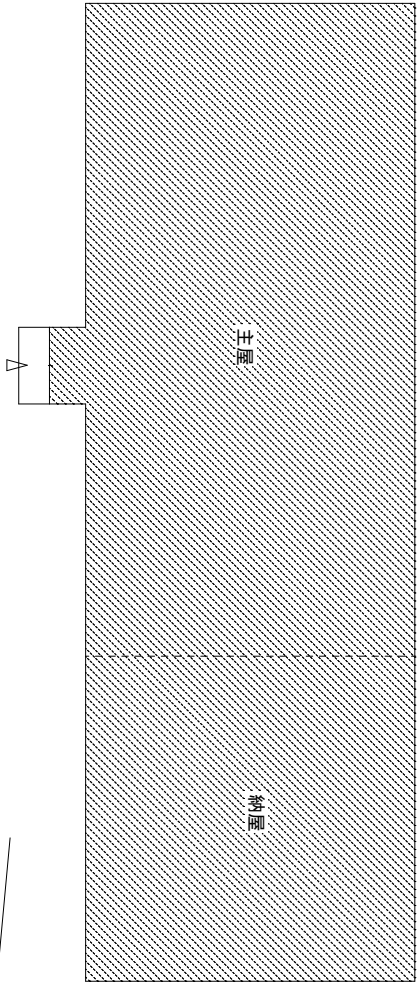
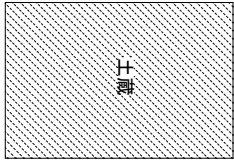
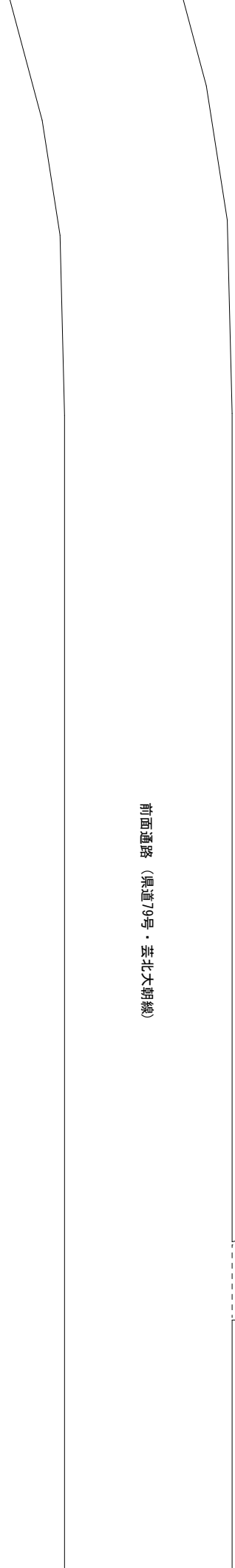

土蔵

住宅
【木造平屋建て】

2階

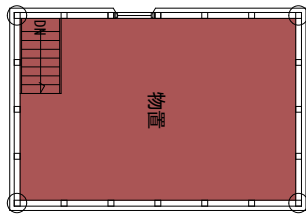

主屋・納屋

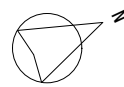

【床面積】

主屋・納屋 223.45 m² (67.59坪)

土蔵 1階 21.89 m²

2階 21.89 m²

計 43.78 m²

車庫 18.24 m²

延べ床面積 285.47 m²

1階

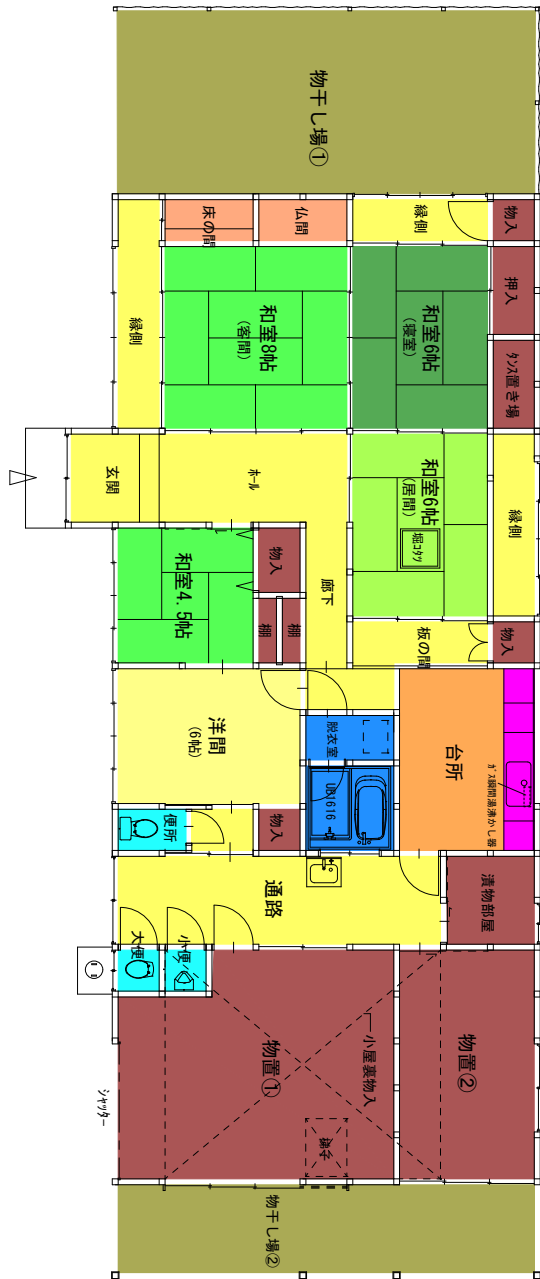
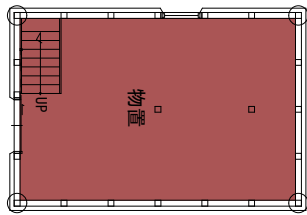

車庫

